

Swivel hook Crosby L-322 AN

Product information



Features:

- Suitable for positioning of the hook before the load is lifted.
- Swivel hooks are load rated.
- Proper design, careful forging, and precision controlled quench and tempering gives maximum strength without excessive weight and bulk.
- Hoist hooks incorporate markings forged into the product which address two (2) QUIC-CHECK®
- Deformation Indicators -- Two strategically placed marks, one just below the shank or eye and the other on the hook tip, which allows for a QUIC-CHECK® measurement to determine if the throat opening has changed, thus indicating abuse or overload.
- Angle Indicators — Indicates the maximum included angle which is allowed between two (2) sling legs in the hook. These indicators also provide the opportunity to approximate other included angles between two sling legs ... [Read more](#)

Material: Alloy steel - Forged, Quenched & Tempered.

Marking: CE-marked

Note: This hook is a positioning device and is not intended to rotate under load.

Safety factor: 4:1

Grade: 8

Swivel hook Crosby L-322 AN

Blueprint

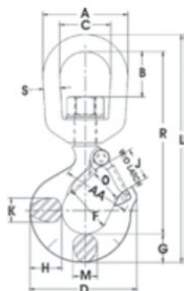

Technical data

Part code	WLL ton	EWL mm	A mm	B mm	C mm	D mm	F mm	G, mm	H, mm	L mm	O*mm mm	Rmm mm	S mm	AA**mm mm	Weight kg
420500320750	3.2	165	76	38.1	44.5	102	41.1	28.7	33.3	210	29.5	165	16	50.8	1.04
420500540750	5.4	191	89	41.7	50.8	123	51	36.6	41.4	246	35.8	191	19.1	63.5	2.25
420500800750	8	245	116	58	63.5	160	63.5	46	52.5	317	42.9	245	25.4	76.2	4.67
420501150750	11.5	289	127	62	70	192	76	57	67	375	56.5	289	28.7	101	8.8