

## Wedge Socket Crosby S-421T

### Product information



### Features:

- Secures the tail or “dead end” of the wire rope to the wedge, thus eliminates loss or “Punch out” of the wedge.
- Eliminates the need for an extra piece of rope, and is easily installed.
- The TERMINATOR™ wedge eliminates the potential breaking off of the tail due to fatigue.
- The tail, which is secured by the base of the clip and the wedge, is left undeformed and available for reuse.
- Incorporates Crosby’s patented QUIC-CHECK™ “Go” and “No-Go” feature cast into the wedge.
- Utilises standard Crosby Red-U-Bolt wire rope clip.
- Generates a minimum efficiency of 80% based on the catalogue breaking strength of the wire rope.
- Pin diameter and jaw opening allows wedge and socket to be used in conjunction with open swage and spelter sockets.

Wedge sockets meet the performance requirements of Federal Specification RR-S-550F, Type C, except those provisions required of the contractor.

[... Read more](#)

**Material:** Cast Steel.

**Marking:** According to standard, ID code and Manufacturer's symbol.

**Finish:** Painted.

**Standard:** EN 13411-6

**Safety factor:** 5:1

## Wedge Socket Crosby S-421T

### Blueprint

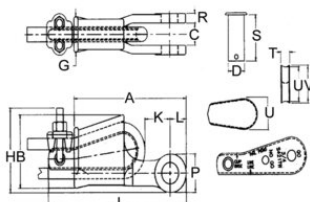

### Technical data

Part code	Rope Ø range mm	Finish	A mm	B mm	C +/- 2.29 mm mm	D mm	G mm	H mm	J* mm	K* mm	L mm	P mm	R mm	S mm	T mm	U mm	V mm	Weight kg
121501000115	9-10	Painted	145	69,1	20,6	20,6	35,1	77,7	198	47,8	22,4	39,6	11,2	54,1	11,2	31,8	35,1	1.44
121501300115	11-13	Painted	175	88,1	25,4	25,4	41,1	95,5	226	32,0	26,9	49,3	12,7	65,0	13,5	44,5	47,8	2.79
121501600115	14-16	Painted	210	109	31,8	30,2	53,8	114	273	50,5	31,0	57,2	14,2	82,6	17,5	51,0	55,5	4.4
121501900115	18-19	Painted	251	130	38,1	35,1	62,0	134	314	61,2	35,6	66,8	16,8	92,2	19,8	59,5	65,0	6.58
121502200115	20-22	Painted	286	149	44,5	41,4	68,5	156	365	63,0	42,4	79,5	19,1	109	22,4	68,5	74,5	9.75
121502600115	24-26	Painted	325	161	51,0	51,0	74,7	177	414	77,2	51,0	95,5	22,4	119	26,2	73,0	83,5	13.9
121502800115	28	Painted	365	176	57,0	57,0	84,0	194	466	65,0	57,0	108	25,4	138	27,9	82,6	90,5	20.5
121503200115	30-32	Painted	415	222	66,5	63,5	90,5	239	520	74,7	59,5	114	26,9	156	30,2	117	125	29.4