

# Lifting Eye Bolt DIN580 Electro Galvanized

---

## Product information

**Material:** Steel  
**Marking:** CE-marked  
**Finish:** Electro Galvanized



# Lifting Eye Bolt DIN580 Electro Galvanized

## Blueprint

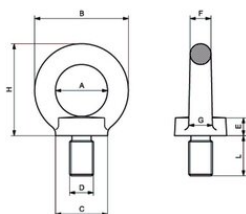

## Technical data

Part code	WLL ton	Thread mm	WLL 90° ton	Tightening torque Nm	WLL 0-45° ton	A mm	B mm	C mm	E mm	F mm	G mm	H mm	L mm	Weight kg
421100011132	0.09	M06	0.038	3.5	0.055	20	36	20	6	8	10	36	13	0.06
421100011130	0.14	M08	0.07	8	0.1	20	36	20	6	8	10	36	13	0.05
421100021130	0.23	M10	0.115	16	0.17	25	45	25	8	10	12	45	17	0.09
421100031130	0.34	M12	0.17	28	0.24	30	54	30	8	12	14	53	20.5	0.16
421100071130	0.7	M16	0.35	70	0.5	35	63	35	12	14	16	62	27	0.24
421100121130	1.2	M20	0.6	135	0.86	40	72	40	14	16	19	71	30	0.36
421100181130	1.8	M24	0.9	230	1.29	50	90	50	18	20	24	90	36	0.72
421100321130	3.2	M30	1.6	465	2.3	60	108	65	22	24	28	109	45	1.32