

Side Pull Hoist Ring Crosby HR-1200 UNC

Product information

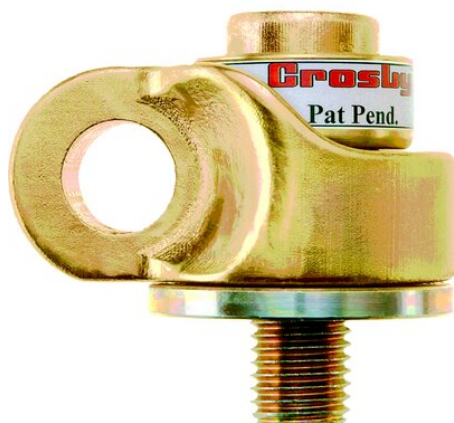

Side Pull Hoist Ring HR-1200 UNC from Crosby.
Utilize standard Crosby Red Pin® Shackles to connect to wire rope or synthetic slings. (sold separately).

... [Read more](#)

Material: Alloy Steel, Quenched and Tempered

Marking: CE-marked

Finish: Yellow Chromate

Side Pull Hoist Ring Crosby HR-1200 UNC

Blueprint

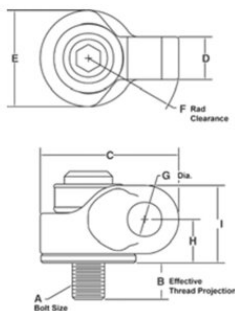

Technical data

Part code	WLL ton	Thread Inch	B mm	C mm	D, mm	E mm	F mm	G, mm	H, mm	I mm mm	Weight kg
42151067740	3.63	1-8x3.00	29.2	110	34	76.2	76.2	27.2	34.3	61.5	2.18
42151067748	6.35	1-1/4-7x4.5	56.4	142	39.9	95.3	99.3	37.3	48.8	86.9	4.63