

## Swivel Jaw & Jaw Crosby AS-2

---

### Product information



Swivels with jaw-jaw, designed for high rotation speed.

- Lower torque required to initiate rotation.
- Angular contact bearings maximize efficiency, reliability, and service life of swivel and extend the life of the wire rope.
- Entire swivel is zinc plated to resist corrosion.
- Individually Proof Tested to 2 times the Working Load Limit with certification.
- Hook models utilize genuine Crosby hooks which are forged alloy steel, quenched and tempered, and contain patented QUIC-CHECK® markings.
- Each swivel 7.65 metric tons and larger is furnished with a pressure lubrication fitting.

... [Read more](#)

---

**Marking:** CE-marked

**Safety factor:** 5:1

## Swivel Jaw & Jaw Crosby AS-2

### Blueprint

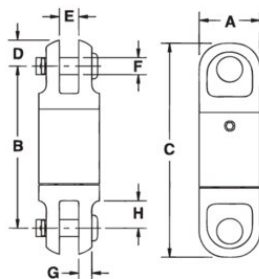

### Technical data

Part code	WLL ton	A mm	B mm	C mm	D mm	E mm	F mm	G mm	H mm	Weight kg
422500070400	0.68	33.3	90	113	11.2	7.85	9.65	5.6	14.2	0.41