

## Stainless Fork Terminal

---

### Product information

Fork terminals are amongst the most commonly used wire end fittings. These terminals are to be swaged on the steel wire ropes with special swage equipment.

In use, they are normally attached to pre drilled anchor plates or steel constructions. Also used in combination with toggles, eyes or U-bolts.

... [Read more](#)



---

**Material:** Stainless steel AISI 316.

**Marking:** Logo, wire size and swage depth.

**Temperature range:** -50°C to +100°C and briefly up to +200°C

**Finish:** Polished.

**Note:** Small fork head design is square - from Ø 19 mm pin and up the design is rounded,

**Warning:** Do not apply to the cable yourself without using suitable swaging equipment.

## Stainless Fork Terminal

### Blueprint

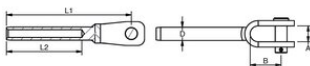

### Technical data

Part code	Rope diameter mm	Pin diameter mm	MBL ton	A mm	B mm	D mm	L1 mm	L2 mm	Weight kg/100pc
1207100504	4	6	0.8	7,5	12	7,5	71	45	2.7
1207100605	5	6	1.5	9,5	13	9,0	83	51	4.1
1207100806	6	8	3.2	11	15	12,6	99	64	10
1207101208	8	12	6.5	14	25	16,0	136	83	21.6
1207101410	10	14	9.4	18	32	17,8	151	89	35