

Beam Clamp Superclamp BFC

Product information

Offers the benefit of maximum adjustment to fit standard dimensions of bulb flats steel sections. Developed for a multitude of applications in civil and marine engineering, construction and maintenance.

Proof load: 2 x WLL.

[... Read more](#)



Finish: Yellow painted.

Note: All WLL apply to vertical lifting only.

Safety factor: 5:1.

Beam Clamp Superclamp BFC

Blueprint

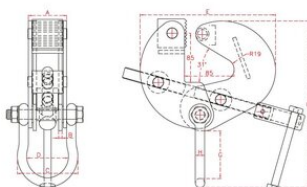

Technical data

Part code	Code	WLL ton	Jaw width mm	A mm	J mm	K mm	Weight kg
502100100831310	BFC1	1	23-83	23-83	89	6	7
502100300831310	BFC2	3	23-83	23-83	95	10	12