

Alloy Bolt Type Anchor Shackle Crosby G-2140

Product information

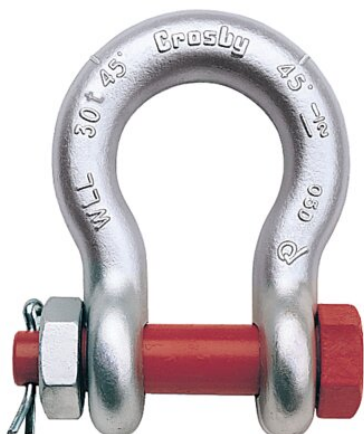

Shackle with bolt and nut. All sizes are individually proof loaded 2 x WLL

Standard: US Fed. Spec. RR-C-271F/ approved according to DNV 2.7-1.

Safety Factor: 4,5:1 on sizes 2-21t, 5,4:1 on sizes 30-175t and 4:1 on sizes 200-400t.

... [Read more](#)

Material: Alloy steel.

Marking: According to standard, CE-marked, WLL, batchnumber, serial number on sizes exceeding 200 tons, angle indicator 45°, RFID on all sizes.

Finish: Galvanized with painted bolt.

Standard: US. FED. SPEC. RR-C-271, ASME B30.26

Note: Specially ordered shackles can be marked and supplied with documentation according to DNV and Lloyds, or other certifying unit.

Grade: 8

Alloy Bolt Type Anchor Shackle Crosby G-2140

Blueprint

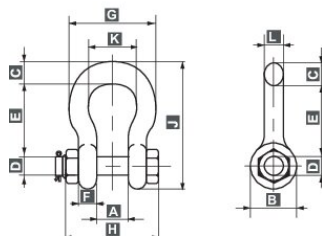

Technical data

Part code	Code	WLL ton	A mm	B mm	C mm	D mm	E mm	F mm	G, mm	H, mm	J mm	K mm	L mm	A Tolerance +/- mm	D Tolerance +/- mm	E Tolerance +/- mm	Weight kg
420100270270	G2140-2,6	2.66	19.1	26.9	11.2	12.7	42.9	10.4	51.6	63.8	73.9	29.5	11.2	1.5	0.3	3.3	0.22
420100950270	G2140-9,3	9.5	36.6	53.1	24.6	25.9	84.1	20.6	102.4	122.4	148.1	57.9	22.4	1.5	0.5	6.4	1.79
420101250270	G2140-12,3	12.5	42.9	60.5	26.9	29.2	95.3	23.4	119.1	136.9	166.6	68.3	25.4	1.5	0.5	6.4	2.57
420102100270	G2140-21	21	57.2	84.1	38.1	38.9	133.4	32.5	162.1	183.1	232.7	92.2	36.1	3.3	0.8	6.4	7.17
420103000270	G2140-30	30	60.5	91.9	41.1	41.4	146	35.3	175	196	254	98.6	38.9	3.3	0.8	6.4	8.53
420104000270	G2140-40	40	73.2	106	57.2	50.8	178	44.5	224	237	313	127	46.7	3.3	0.8	6.4	15.3
420105500270	G2140-55	55	82.6	122	61	57.2	197	50.8	258	264	347	146	52.8	3.3	0.8	6.4	22.6
420108500270	G2140-85	85	105	148	79.2	69.9	267	66.5	324	345	455	184	68.8	6.4	0.8	6.4	46.7
420112000270	G2140-120*	120	127	165	92.2	82.6	330	76.2	371	384	546	200	79.2	6.4	1	6.4	73.5