

Lifting Eye with standard Coupling Link Starcon

Product information

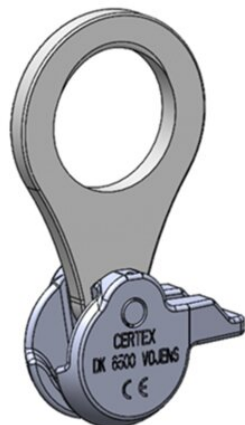

Starcon lifting eyes are made of a special cast steel alloy which after hardening obtains an exceptionally high strength. The strength of the material exceeds a safety factor of 5.

... [Read more](#)

Marking: Load group, STARCON, serialnumber, CE

Lifting Eye with standard Coupling Link Starcon

Blueprint

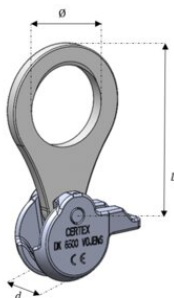

Technical data

Part code	WLL t	dmm mm	L mm	Ø mm mm	Weight kg
650220013001	1.0-1.3	34	130	42	0.61
650220025001	1.5-2.5	42	165	60	1.12
650220050001	3.0-5.0	55	200	62	2.39
650220100001	6.0-10.0	74	285	100	5.6